

STUB ARBOURS

ISO TYPE

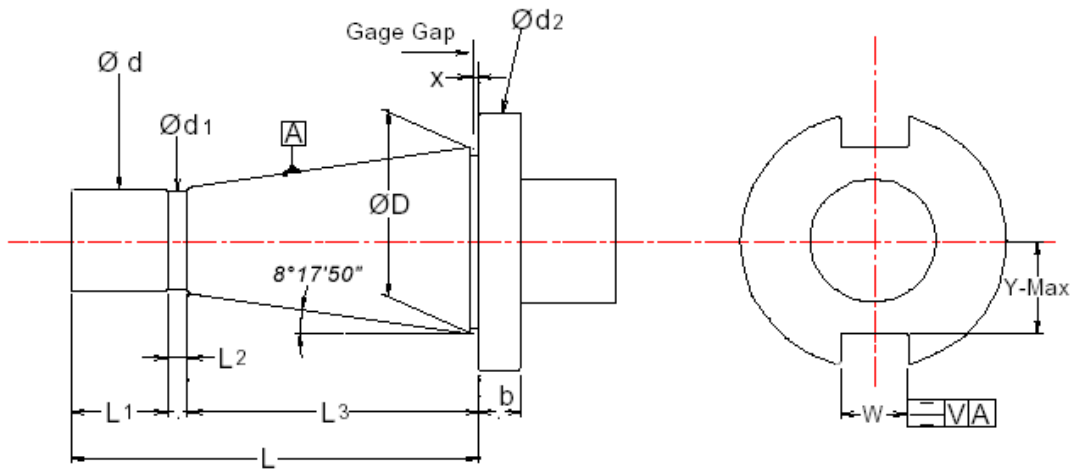

7/24 Taper	$\varnothing D$	$\varnothing d$	$\varnothing d_1$	$\varnothing d_2$	L	L_1	L_2	L_3	b	W H 12	Y Max	x
ISO 30	31.75	17.4	16.5	50	70	17	3	50	8	16.1	16.2	1.6
ISO 40	44.45	25.3	24	63	95	23	5	67	10	16.1	22.5	± 0.4
ISO 50	69.85	39.6	38	100	130	17	8	105	12	25.7	35.3	3.2
ISO 60	107.95	60.2	58	160	210	35	10	165	16	25.7	60	± 0.4

Note:

- *Manufactured to DIN 2080 / IS:2340-1972*
- *Also available in Morse Taper, R8 and BT type shanks on request.*